

Alarm Sound's

- H2S Alarm
- H2S Alarm perimeter
- Fire Alarm
- Gas/Oil kick

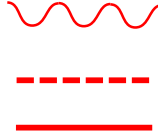

All standard PPE must be carried on the Drilling rig.

Actions when H2S Alarm activate:



- Stop work
- Use NH 15 (Visitors) or BA sets (Rig crew)
- Determine wind direction by wind socks.
- Proceed to the muster point from the upwind side.
- Stay in row by 5 people and wait for the end of headcount
- Proceed to the evacuation buses.
- Wait for instructions

Information for drivers

Speed limit on rig site not more than 5 km/h

Vehicle must park on to the parking area with reverse movement.

Evacuation buses park near Muster Point's depending on wind direction.

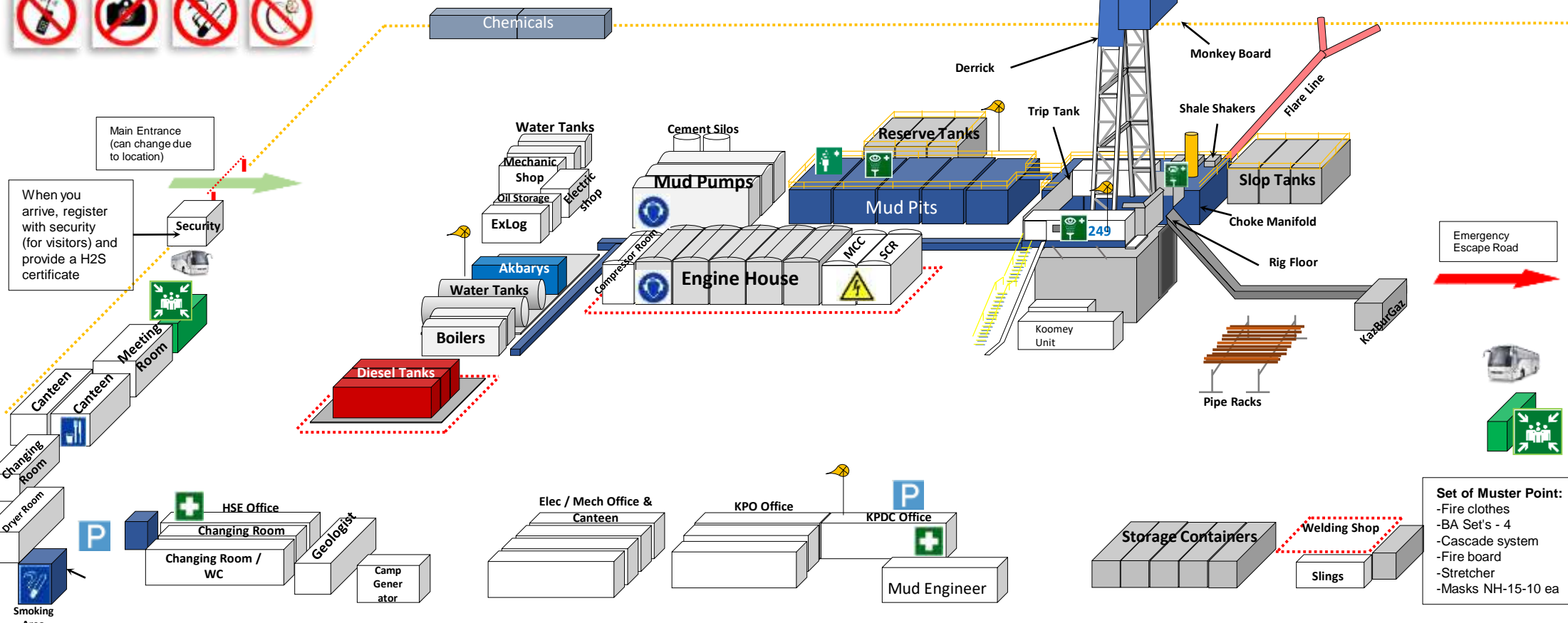

- #### Set of Muster Point:
- Fire clothes
 - BA Set's - 4
 - Cascade system
 - Fire board
 - Stretcher
 - Masks NH-15-10 ea



Welcome to Drilling Rig 249

- ✓ When you arrive, register with security (for visitors) and provide a certificate H2S
- ✓ During the first visit, pass additional instruction on hydrogen sulfide from Akbarys representative
- ✓ All standard PPE must be carried on the Drilling rig.
- ✓ All operational personnel should be trained for H2S by KPO, Minimum Fire Safety compliance, Industrial Safety, Labour Safety
- ✓ Contact HSE supervisor for work permit forms
- ✓ Cell phones, cameras and other electronic devices, excluding protected models, are prohibited.
- ✓ Any jewelry is prohibited on the drilling rig
- ✓ Three-point contact must be maintained when using stairs/ladders
- ✓ Smoking is only at designated smoking area

Position	Contact numbers
KPO Drilling Supervisor (24 hours)	+7 777 355 38 94 / 4030
Rig Manager (24 hours)	+7 777 201 49 64 / 4034
HSE Supervisor (24 hours)	+7 777 075 08 95 4077
Drilling Base Doctor (24 hours)	+7 777 214 96 47
Radio operator (24 hours)	+7 777 221 41 18 4024
Drilling base HSE Coordinator (12 hours / Day Shift)	+7 777 220 8837 / 4025

If a hazard or unsafe behavior is observed, all workers are entitled to intervene and if necessary stop the work



All interventions and identified hazards should be reported to the Supervisor and a HSE card submitted.



If you were involved or witnessed the incident, report it to the Emergency Communications Center operator(ECC). Report the incident to your direct supervisor

KPO ECC Operator
Dial from mobile phone:
+7-705-939-3333

The order of carrying the wear escape mask hood (NH-15) and the personal H2S Gas Detector



Personal H2S gas detector (BW Clip) must be fixed on top of coverall at breathing level.

- ✓ Check the condition of the "alligator" clip.
 - ✓ Make sure the detector is properly fastened.
- NH-15
- ✓ Regular inspection of the vacuum seal package is needed to confirm equipment is operational.
 - ✓ Filter hood can be carried at the waist rover the shoulder. The bag cover shall be positioned at the top.



Depending on the type of work and hazards, you may need additional PPE. Follow the requirements specified in the PTW, RAMS / WSP, and the Safety Data Sheet (when working with chemicals). Know the location of special PPE, first-aid kit, eye wash station



"7 Step" Safe Work Process

"Starting Work in Not Step # 1"

1	Plan	<ul style="list-style-type: none"> ✓ Work Safe Procedure ✓ Pre Tour / Work Instruction ✓ ORM / Hazard Assessment Work Safe procedure Needed? ✓ Supervisor & Verifier Allocated
2	Communicate	<ul style="list-style-type: none"> ✓ Pre Job Safety Meeting / Client / All Contractors involved ✓ Roles allocated and understood ✓ Personal and Process Safety* ✓ Change Management & MOC
3	Check Equipment	<ul style="list-style-type: none"> ✓ Certified ✓ Rated ✓ Tested ✓ Fit for Purpose ✓ Calibrated ✓ No Damage ✓ Back Up Ready
4	Prepare Area	<ul style="list-style-type: none"> ✓ Flat and Level ✓ Housekeeping ✓ Red Zones, Barriers, Permission; ✓ Above / Below / Beside ✓ SIMOPS?
5	Control Energy	<ul style="list-style-type: none"> ✓ Isolate (Lock Out, Tag Out and Test) ✓ Drain Stored Energy (Gauge?) ✓ Line of Fire/Escape Routes
6	Final Check	<ul style="list-style-type: none"> ✓ 100% Ready to Go ✓ Contingencies in Place ✓ Emergency Response Plans ✓ Walk the Line P&ID
7	Start Work	<ul style="list-style-type: none"> ✓ Comply/Intervene/Respect ✓ Follow Life Saving Rules ✓ Well Barriers/MOC/Stop Work Authority ✓ Hands Free/Red Zones/Change

After Action Review

Lessons Learned and Opportunities for Improvement

"Starting Work is Step Number 7"

* What are we doing? What are the Hazards and Controls? What could go wrong? What would we do? What if this happens? What are our Barriers? What would you Stop the Job for? What Change do we have today? What worries you?